

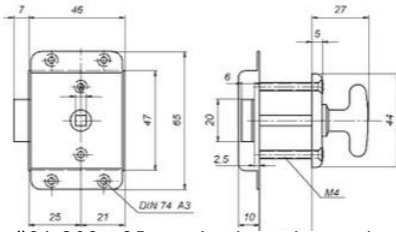

Izerwaren
Order
numbers

• Brass cabinet latches and locks
Finish: Chrome plated brass
Marine Rim Latches (Slam Latch Action)

21.309 **Latch #4309;** 25 mm backset,
for 5 x 5 mm spindle; with strike
Case 46 x 65 mm
polished chrome plated brass
Knob set #4309K separate order
Strike #4309S



Latch #21.309; 25 mm backset, brass chrome plated 5 x 5 mm spindle with knob + rose



21.709-25 **Latch #3709;** 25 mm backset,
for 7 x 7 mm spindle; with strike
Case 50 x 78 mm
polished chrome plated brass
Strike #3709S

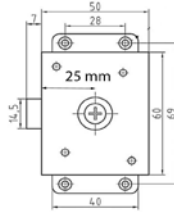

Latch #21.709-25; 25 mm backset brass chrome plated 7 x 7 mm spindle



21.709-30 **Latch #3709;** 30 mm backset,
for 7 x 7 mm spindle; with strike
Case 50 x 78 mm
polished chrome plated brass
Strike #3709S

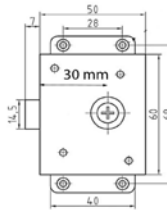

Latch #21.709-30; 30 mm backset, brass chrome plated 7 x 7 mm spindle SET: 21.719-30 #16.087 oval knob with #oval rose



21.711Z **Latch #3711Z;** 30 mm backset,
With cylinder keyway in knob;
with strike
Case 50 x 78 mm
polished chrome plated brass with
steel parts

21.711K **Latch #3711K;** 30 mm backset,
With Knob and with strike
Case 50 x 78 mm
polished chrome plated brass
thickness of door 3/4".

Marine Rim Lock

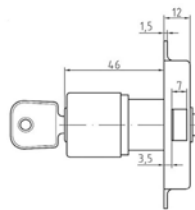

latch #21.711Z; 30 mm backset, brass chrome plated

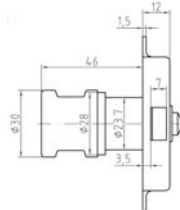

21.711K



21.73Z **Deadbolt #3273Z;**
25 mm backset,
(also avail. 20, 30 mm backset)
With cylinder keyway, with strike
Case 45 x 78 mm
polished chrome plated brass
thickness of door 3/4".

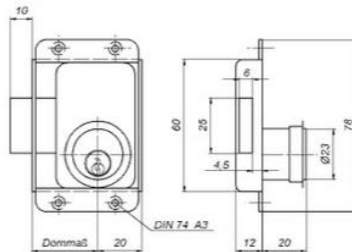

latch #3273Z; 25 mm backset, brass chrome plated; also with 20, 30 mm backset For door thickness from 5/8" to 1 3/16.



Push Pin Marine Rim Latches (with Slam Latch Action)



#21.515 Push Pin Latch;
15 mm (5/8 inch) backset



#21.503 Push pin Latch
22.5 mm (3/4 inch) backset



#24.1520 Push Pin latch with pull
15 mm (5/8 inch) backset



#24.5175 Pull separate

For more exterior grade marine slam latches with push pin see page 2-1-A



Izerwaren
Order

- Cabinet Rim 2 point lock.
- Two point rim lock with round rods
- To open: turn knob 1/4 to left or right
- Specify left or right
- Minimum door thickness: 13/16 inch

**Rim 2 point lock mechanism
Left hand**

22.300L

Right hand

22.300R

23.204 **SET: With round rod with 2 guides, 2 connectors
2 rods of 500 mm long; 2 filler plates**

Lock Case 152 x 38 mm. Throw: 18 mm 3/4"
Case stainless steel
For 7 x 7 mm spindle; for front and/or back
mounted turning knobs or levers
with round stainless steel rods, guides and
strikes

Specify right or left hand when ordering

62.816L **Guides; stainless steel for 8 mm rod**



23.300C **Rod Coupling, stainless steel**

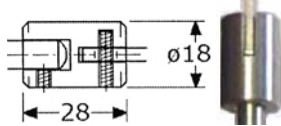

23.300F **Filler Plate for mechanism, white plastic**



23.300D **Rods, 8 mm (5/16") diameter,
stainless steel - specify length**

Flush Turning lever:



43.996 #43.996 flush turning lever
Dimension: 70 x 70 x 14 mm
or 2 3/4 x 2 3/4 inch
Minimum hatch thickness: 21mm / 13/16 inch.
Material: 316 stainless steel

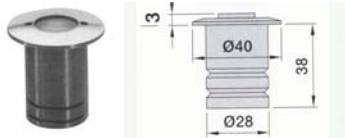

32.K42 Closed Receiver Cup #32.K42.
Stainless steel house with moving nylon spring
loaded insert. Spring: stainless steel.
Dimension: 1 1/8" diameter x 1 1/2" high
Top Plate: 1 9/16" x 1/8" thick



23.2424 Open receiver cup #24.2424
11 long x 17 mm diameter body, top 20 mm diameter
0.6690" x 0.7875" x 0.5" deep

**2 point rim lock for exterior and interior use
316 stainless steel for 13/16" doors**

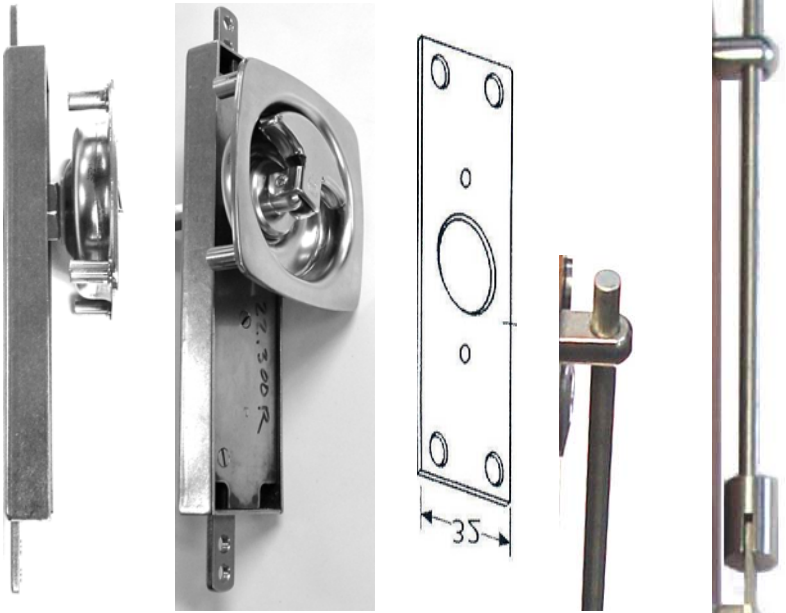

23.204 SET 2 point rim lock; stainless steel with round rods,
connectors, guides, nylon filler plates
lock has 7x7 mm square hole for flush turning lever (separate)

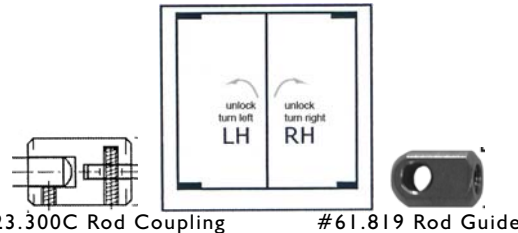

SET: #23.204; 316 stainless steel
2 point lock with 2 round rod 8 x 500 mm;
With 2 guides and 2 couplings and 2 filler plates.
#23.300D: 2 Rods; 8 x 500 mm; 2 Guides #62.816L; 2 Coupling #23.300C
Please Order Separate:
Open Receiver Cup: #23.2424; or Closed Receiver Cup #32.K42 Flush
Turning Lever #43.966



Izerwaren
Order
numbers

- 316 Stainless steel slam latch with lift ring
- sea water resistant
- slam action when closing
- strike included
- finish: Lift ring polished stainless steel 316; body and cam: satin finish

SLAM LATCH WITH LIFT RING

Polished 316 stainless steel



- 43.F01 **Slam latch for hatches**
Set: latch, mounting ring with screws; strike.
Diameter: 2 3/8"
Built in diameter: 2"
Material thickness: from 1/4" up to 13/16"
Spring loaded slam action on latch bolt
- 43.F02 **Slam latch for hatch, locking with key**

Slam latch #43.F01

Installation body: Drill hole: 2" Ø



Mounting ring; 2 3/8" diameter

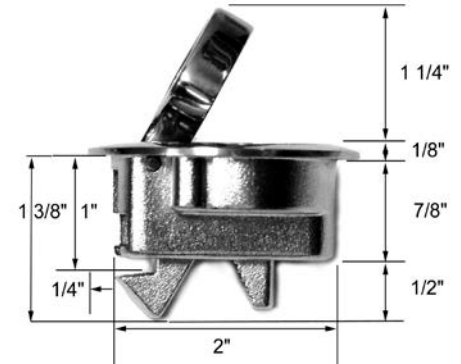

#43.F01 Slam latch

SLAM LATCH WITH PULL



- #43.831S Flush Slam latch, Pull type. Anchor style lift ring; strike plate included. **Pull Out** to release.
Dimensions: 61 mm long (A) x 58 mm wide (C) x 19 mm deep (D). Door thickness: 19 mm
Dimensions: 2 7/16" (A) x 1 1/2" (B) x 2 1/4" (C) x 3/4" (D) Door thickness: 3/4"
316 stainless steel Satin Finish

SLAM LATCH WITH LIFT RING



- #46.108 Flush Pull Lift with latch Dimension: 60 x 40 x 15 mm;
Angle strike 15 x 15 x 42 mm; Door thickness: 5/8" or 15 mm

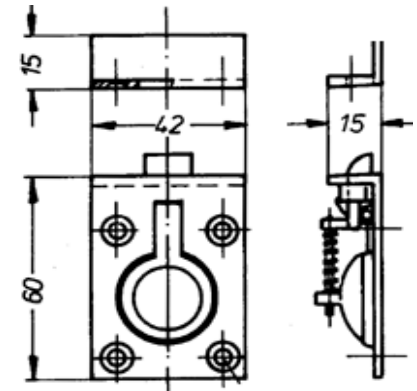

Pull Out to release



Izerwaren
Order
numbers

• Brass cabinet latches and locks
Finish: Chrome plated brass
Marine Rim Latches (Slam Latch Action)

21.309 **Latch #4309;** 25 mm backset, for 5 x 5 mm spindle; with strike Case 46 x 65 mm polished chrome plated brass Knob set #4309K separate order Strike #4309S

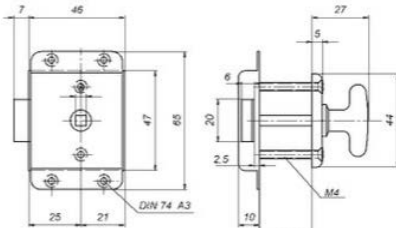

Latch #21.309; 25 mm backset, brass chrome plated 5 x 5 mm spindle with knob + rose



21.709-25 **Latch #3709;** 25 mm backset, for 7 x 7 mm spindle; with strike Case 50 x 78 mm polished chrome plated brass Strike #3709S

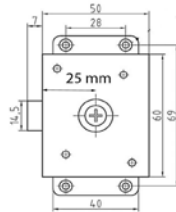

Latch #21.709-25; 25 mm backset brass chrome plated 7 x 7 mm spindle



21.709-30 **Latch #3709;** 30 mm backset, for 7 x 7 mm spindle; with strike Case 50 x 78 mm polished chrome plated brass Strike #3709S

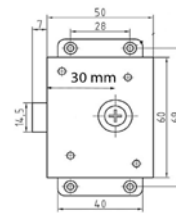

Latch #21.709-30; 30 mm backset, brass chrome plated 7 x 7 mm spindle SET: 21.719-30 #16.087 oval knob with #oval rose



21.711Z **Latch #3711Z;** 30 mm backset, With cylinder keyway in knob; with strike Case 50 x 78 mm polished chrome plated brass with steel parts

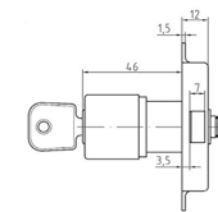

latch #21.711Z; 30 mm backset, brass chrome plated

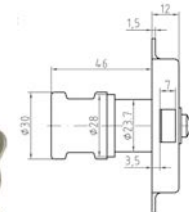

21.711K **Latch #3711K;** 30 mm backset, With Knob and with strike Case 50 x 78 mm polished chrome plated brass thickness of door 3/4".

Marine Rim Lock

21.711K

21.73Z **Deadbolt #3273Z;** 25 mm backset, (also avail. 20, 30 mm backset) With cylinder keyway, with strike Case 45 x 78 mm polished chrome plated brass thickness of door 3/4".

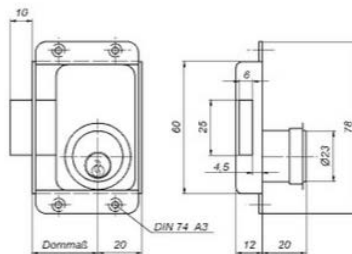

latch #3273Z; 25 mm backset, brass chrome plated; also with 20, 30 mm backset For door thickness from 5/8" to 1 3/16."



Push Pin Marine Rim Latches (with Slam Latch Action)



#21.515 Push Pin Latch; 15 mm (5/8 inch) backset



#21.503 Push pin Latch 22.5 mm (3/4 inch) backset



#24.1520 Push Pin latch with pull 15 mm (5/8 inch) backset



#24.5175 Pull separate

For more exterior grade marine slam latches with push pin see page 2-1-A



Izerwaren
Order
numbers

21.515 **Finger pull (5160/61)**
with elbow catch, strike and.
latch operates by pulling lever with
finger, through hole in door.
Cover ring in hole in door:
drill 29 mm hole; OD: 34 mm ID: 23 mm
strike plate included; both handed

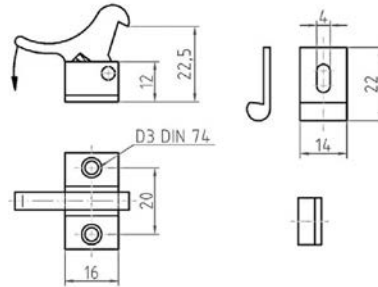

21.2801 **Ring (631.02.801) Brass Polished**
Diameter 35 mm; 18 mm high;

21.2701 **Ring (631.02.701) Satin Nickel**
Diameter 35 mm; 18 mm high;

Finger pull #21.515 elbow catch; latch operates by pulling lever with finger,
through hole in door. strike plate included; both handed

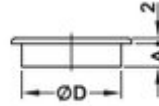

#21.2801 Brass #21.2701 nickel Brass Cover ring for hole in door:
Drill 35 mm hole; D = 35 mm; A = 19 mm

24.160 **Flush Pull Lift with latch (4108)**
Brass, polished chrome plated,
Strike plate included.
Body: 60 x 40 mm - 2 3/8" x 1 9/16";
Strike: 15 x 15 mm - 5/8" x 5/8"
mortise depth: 18 mm - 11/16"

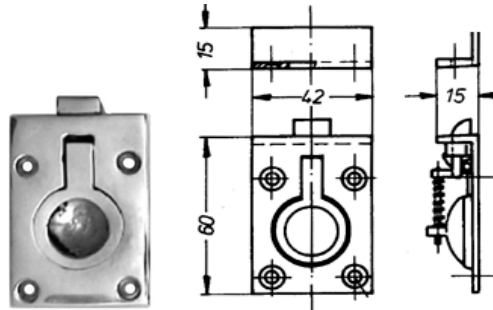

Finger pull catch #24.160 brass chrome plated

46.108 **Flush Pull**
Brass, polished chrome plated,
Dimensions: 52 x 37 x 13mm
mortise depth: 13 mm 5/8"

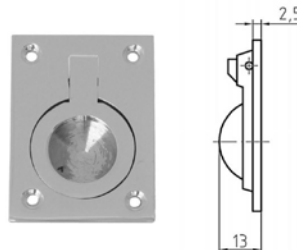

Flush pull #46.108 chrome plated: 52 x 37 mm

46.020 **Flush Pull**
Brass, polished chrome plated,
Dimensions: 85 x 50 x 13mm
mortise depth: 13 mm 5/8"

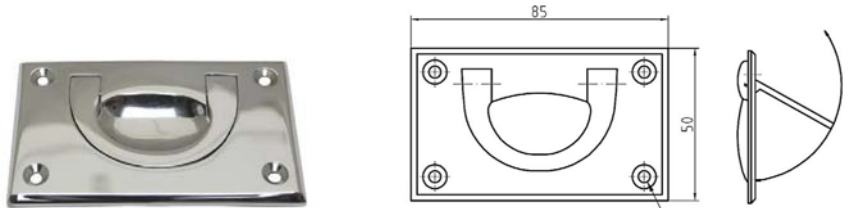

Flush pull #46.020 chrome/brass 85 x 50 mm.

43.214 **Flush Pull** stainless steel
2 1/4" x 3" ~ 57 x 76 mm
316 Cast Stainless steel

43.215 **Flush Pull** stainless steel
Dimensions: 2 1/2" x 1 3/4"
316 Cast Stainless steel

43.216 **Flush Pull** stainless steel
Dimensions: 1 1/2" x 1 15/16"
316 Cast Stainless steel



Flush Pull #43.214
3" x 2 1/4"

#43.215;
1 3/4" x 2 1/2"

#43.216;
1 1/2" x 1 15/16"



Izerwaren
Order
numbers

Offset Slam Latches

Stainless steel and zinc

Latch for flush and overlay doors.
Polished chrome die cast zinc
Available in flush, or 1/8, and 3/8 inch offset.

- 88.2319 SET latch and strike flush
- 88.231 Latch only
- 88.232 88.232 strike flush
- 88.234 88.234 strike 1/8"
- 88.236 88.236 strike 3/8"

Latch for flush and overlay doors.
Polished chrome die cast zinc
Available in flush, with 1/8, and 3/8 inch offset

- 88.2389 SET: Latch and strike flush
- 88.238 88.238 latch only
- 88.239 88.239 strike flush
- 88.241 88.241 strike 1/8"
- 88.243 88.243 strike 3/8"

- 88.470 Latch for flush and overlay doors..
- 88.485 Flush strike (depicted)
- 88.486 Offset strike 3/4" offset (not depicted)

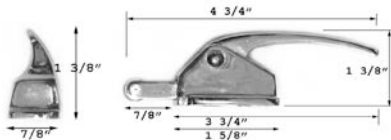

MINI LATCHES

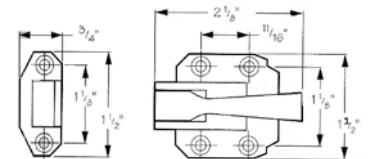

SET: #88.2319 Latch for flush doors with strike. Polished chrome die cast zinc
Base: 1 1/2" x 2 1/8"; Strike 3/4" x 1 1/2". Flush Strike depicted
Available in flush, with 1/8, and 3/8 inch offset.

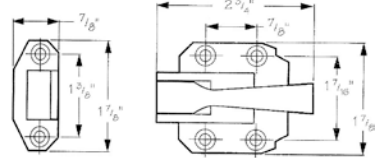

SET: #88.2389 Latch and strike for flush doors. Polished chrome die-cast zinc.
Base: 1 7/8" x 2 3/4"; Strike 7/8" x 1 7/8".
Available in flush, with 1/8, and 3/8 inch offset.

MEDIUM SIZE LATCHES



88.470 Latch for flush and overlay doors. Polished chrome die-cast zinc. Strike sold separate
88.485 Flush strike (depicted)
88.486 Offset strike 3/4" offset (not depicted)

- 88.130 Latch for up lay doors
For flush up to 1/2" inch offset only;
Strike included,
With padlock provision.

STAINLESS STEEL.

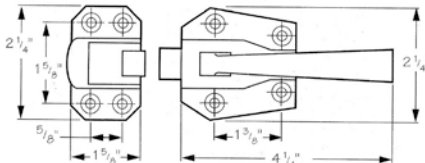

#88.130 Latch for overlay doors with 1/2 inch offset; **stainless steel**, with padlock provision
For flush and 1/2" offset applications
#88.131 for 5/8" to 1 1/4" applications
Base: 2 1/4" x 2 1/2". Strike included

- 88.131 Latch for overlay doors
For 5/8" up to 1 1/4" inch offset only;
Strike included,
With padlock provision

Stainless steel.

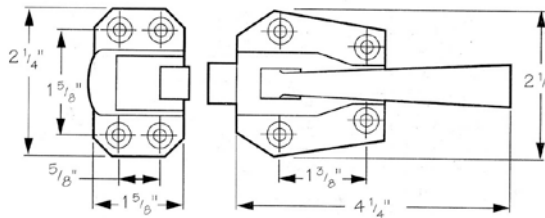

- 42.255 Off set hinge die-cast aluminum
29 x 60 mm; offset 20 mm (3/4 inch)

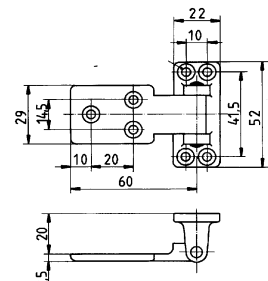

#42.255 door hinge 3/4" offset die-cast aluminum - sizes in mm.



Izerwaren
Order
numbers

Toggle Devices and hatch fasteners
Stainless steel and brass
• seawater resistant

FULL SIZE LATCH 1/2 INCH OFFSET with padlock option

88.163 Latch for up lay doors with 1/2 inch offset; Strike included, with padlock provision **stainless steel**



88.163 Latch for up lay doors with 1/2 inch offset; **stainless steel**, with padlock provision Base 2 5/8" x 3" Strike included

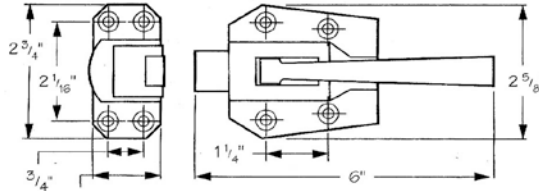

FULL SIZE LATCH 1/2 INCH OFFSET AND FLUSH SETUP

88.066 Latch, toggle style, **stainless steel**
88.067 Strike separate
Adjustable 5/8 to 1 1/4 inch
Mechanism 88.066, strike 88.067



88.067S Strike for flush door application (custom made; special order)

#88.066 Latch for up lay doors with 1/2 inch offset; **stainless steel**, with padlock provision Base 2 5/16 inch x 2 3/16 inch" Strike sold separate
#88.067 Strike for offset adjustable 5/8 x 1 1/4 inch

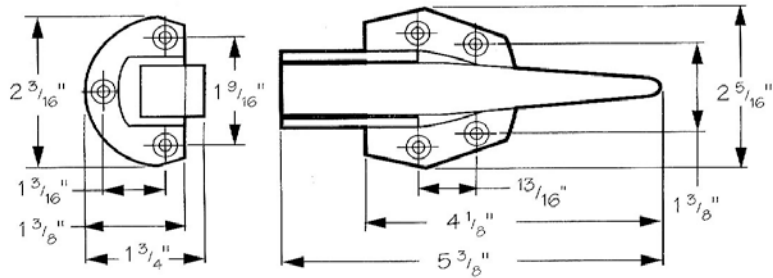

Latch #88.066 with flush strike #88.067S. **Stainless steel**
#88.067S Strike for flush application **stainless steel**



Izerwaren
Order
numbers

Tension catches
316 stainless steel housing, ball
304 stainless springs
Tension adjustable
Seawater resistant

29.040 Tension Catch with Strike 43 mm
1 11/16 x 5/16 x 5/16 inch
Adjustable force, Stainless Steel

29.041 Strike Separate for 43 mm unit

STAINLESS STEEL TENSION CATCHES

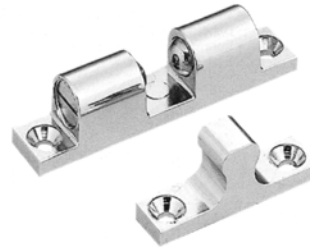

#29.040 Tension Catch; Strike included
Sizes: A = 43 mm long, (1 11/16")
K = 7.5 mm wide (5/16")
G = 7.5 mm high (5/16")

29.050 Tension Catch with Strike 50 mm
1 31/32 x 3/8 x 3/8 inch
Adjustable force, Stainless Steel

29.051 Strike Separate for 50 mm unit

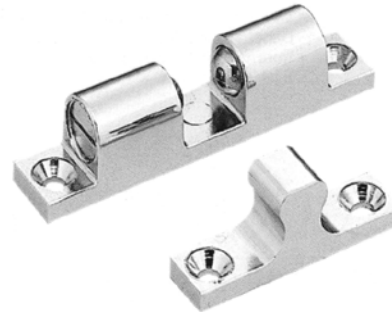

#29.050 Tension Catch; Strike included
Sizes: A = 50 mm long, (1 31/32")
K = 9 mm wide (3/8")
G = 9.3 mm high (3/8")

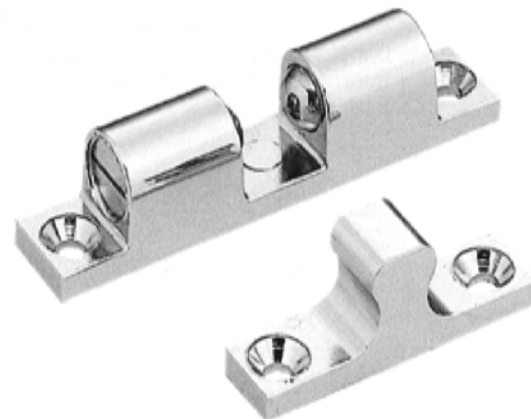
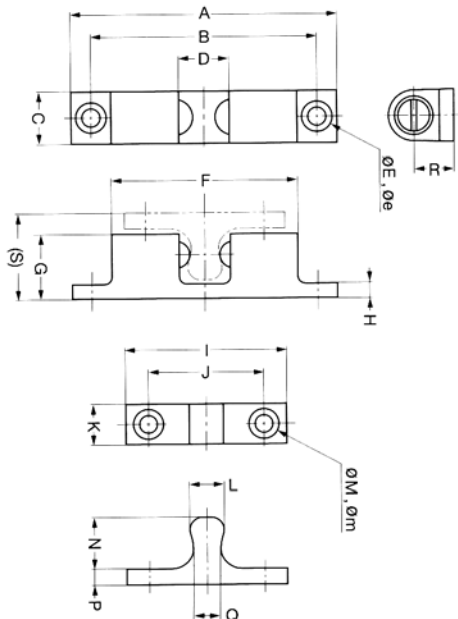

29.070 Tension Catch with Strike 70 mm
2 3/4 x 7/16 x 1/2 inch
Adjustable force, Stainless Steel

29.071 Strike Separate for 70 mm unit

#29.070 Tension Catch; Strike included
Sizes: A = 70 mm long, (2 3/4")
K = 10.5 mm wide (7/16")
G = 13 mm high (1/2")